



# Door Lock

Catalogue

+86-15501571292  
info@ahpbaba.com - www.ahpbaba.com  
B2-1910,Zhengkai Wanda Plaza, Wuhan, China

Hardware

CYLINDRICAL LEVER SERIES

- Special Design for Standard duty.**  
**Meets with ANSI A156.2 Grade 3. Exceeds 250,000 cycles.**
- **Door Prep:** Cross bore 2-1/8"(54mm), Edge bore 1"(25mm), Latch face 1"x2-1/4"(25.4x57mm).
  - **Door Thick:** Fitdoors 1-3/8"(35mm) to 2"(50mm) thick.
  - **Latch:** 2-3/4"(70mm) or 2-3/8"(60mm) fixed standard, adjustable 60/70mm optional.
  - **Cylinder:** 5-pin removable core, Schlage C Keyway or Kwikset, or YALE or C4 keyway and other optional.
  - **Faceplate:** Square corner 1"x2-1/4"(25.4x57mm) standard, radius corner also available.
  - **Strikes:** T-Strike 1-1/2"x2-3/4" (38x70mm) standard, D-Strike 1-1/2" x 2-1/4"(39.5x57mm) optional.
  - **Function:** DM(0:Dummy), ET(1:Entrance), BK(2:Privacy), PS(3:Passage), ST(4:Storeroom).



Wrought stainless steel or brass trim, assembly with steel chassis holds lock firmly provides great strength and durability with zinc chromate plated to resist corrosion.

Push in and turn button function.

1"x2"-1/4"(25x57mm) Square standard, round corner also available.

1/2" throw dead latch completely reversible for flat and beveled doors.

Cylindrical body provides great strength and durability.

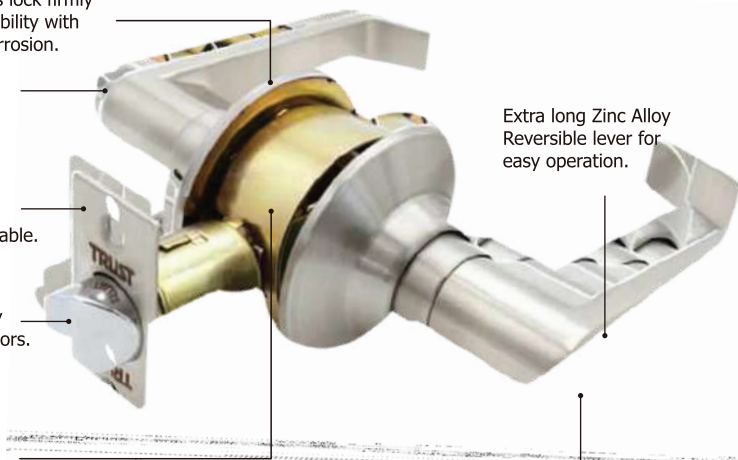

Extra long Zinc Alloy Reversible lever for easy operation.

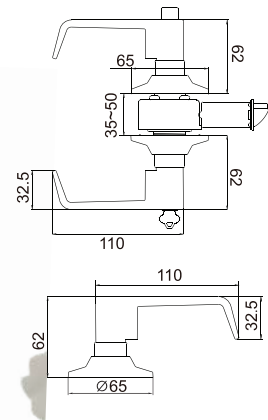

High precision 5-pin tumbler brass cylinder. Brass key nickel plated can be construction keyed and master keyed as required.

3431SN-ET

LEVER HANDLE OPTIONAL

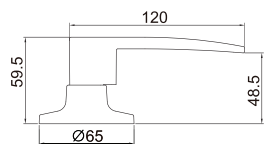

3413RB

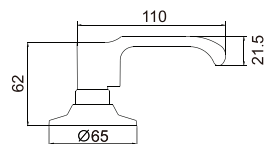

3422MB

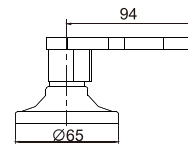

3481SN

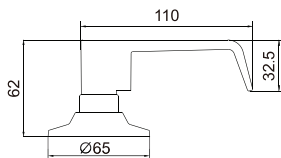

3432SN

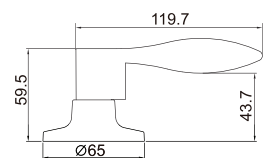

3463RB

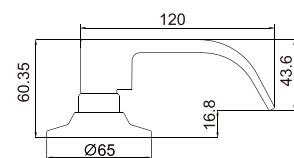

3491SN

MODEL FUNCTION	IMAGE	DESCRIPTION	MODEL FUNCTION	IMAGE	DESCRIPTION
<b>3431 Entrance(ET)</b>		Pushing/turning button locks outside lever only if use key to release the button or tuning inside lever to unlock the lock.	<b>3433 Passage(PS)</b>		Both levers always unlocked.
<b>3432 Bathroom(BK)</b>		Can be opened from outside when turning emergency lot, Pushing/turning button locks outside lever, turning inside lever to release button.	<b>3430 Dummy(DM)</b>		Dummy trim for oneside of door pull function.

### PHYSICAL DISPLAY

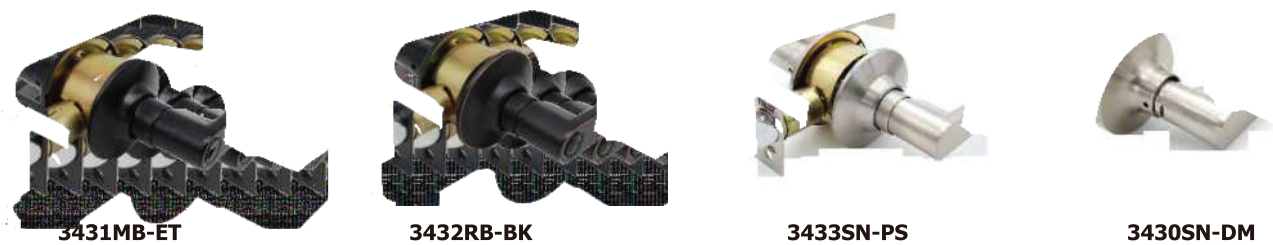

### LATCH OPTIONAL



### STRIKE OPTIONAL

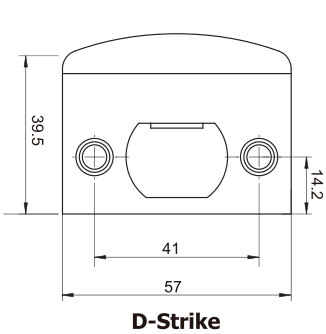
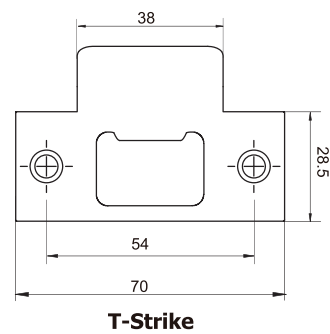

### DOOR PREPARATION

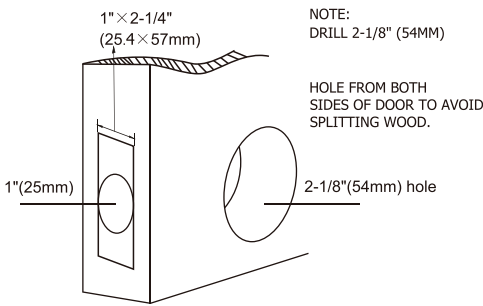

### HOW TO ORDER

**Example:** MODEL: 3431SN-ET  
(US15), Entry 2PC KW Keys, Square Faceplate  
60mm latch, D-Strike

**P.S.: The Finish ,Keyway and Package optional in page 01**

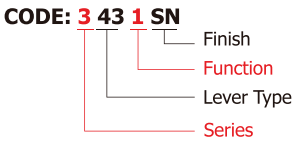

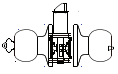
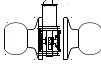
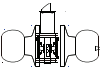
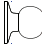
MODEL FUNCTION	IMAGE	DESCRIPTION	MODEL FUNCTION	IMAGE	DESCRIPTION
<b>6871 Entrance(ET)</b>		Pushing/turning button locks outside lever only if use key to release the button or tuning inside lever to unlock the lock.	<b>6873 Passage(PS)</b>		Both levers always unlocked.
<b>6872 Bathroom(BK)</b>		Can be opened from outside when turning emergency lot, Pushing/turning button locks outside lever, turning inside lever to release button.	<b>6870 Dummy(DM)</b>		Dummy trim for oneside of door pull function.

PHYSICAL DISPLAY



STRIKE OPTIONAL

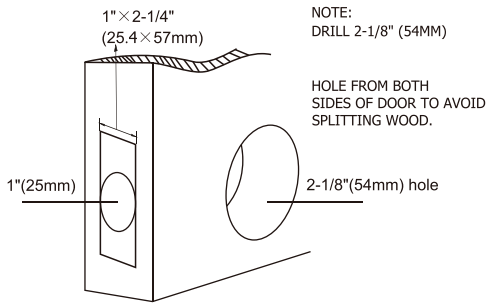
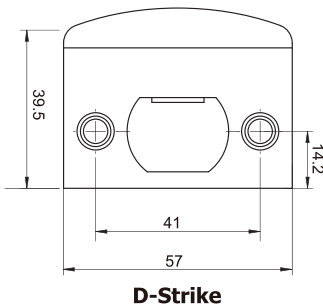
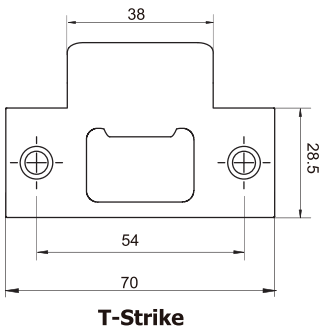

DOOR PREPARATION

HOW TO ORDER

Example: MODEL: 6871SS-ET  
(US32D), Entry 2PC KW Keys, Square Corner  
adj 60/70 mm latch, D-Strike

P.S.: The Finish ,Keyway and Package optional in page 01

CODE: 6 87 1 SS  
Finish  
Function  
Knob Type  
Series



TUBULAR LEVER SERIES

- Special Design for Heavy duty.**  
**Meets with ANSI A156.2 Grade 3. Exceeds 250,000 cycles.**
- **Door Prep:** Cross bore 2-1/8"(54mm), Edge bore 1"(25mm), Latch face 1"x 2-1/4"(25.4x57mm).
  - **Door Thick:** Fit doors 1-3/8"(35mm) to 2"(50mm) thick.
  - **Latch:** Adjustable 2-3/8"(60mm) standard or 2-3/4"(70mm) optional.
  - **Cylinder:** 5-pin removable core, Schlage C Keyway or Kwikset, or YALE or C4 keyway and other optional.
  - **Strikes:** T-Strike 1-1/2"x2-3/4" (38x70mm) standard, D-Strike 1-1/2" x 2-1/4"(39.5x57mm) optional.
  - **Function:** DM(0:Dummy), ET(1:Entrance), BK(2:Privacy), PS(3:Passage).
- MEETS ANSI  
GRADE 3  
HEAVY DUTY  
SPECIFICATIONS

2-1/2" (65mm) square rosette, with heavy duty lever both made of zinc alloy.

Turn button function.

Square-drive spindle structure Individual spring on each side to prevents lever sag maintain reliability.

2-1/4"(57mm) Square standard

1/2" throw adjustable dead latch completely reversible for flat and beveled doors. Steel latch shell.

2-1/2" (65mm) square rosette as standard, 70mm round rosette also available.

Full length lever handle with 45°

High precision 5-pin full brass cylinder. Brass key nickel plated can be construction keyed and master keyed as required.

6911MB-ET

LEVER HANDLE OPTIONAL      ROSE OPTIONAL

6911MB

6931RB

Square

Round

MODEL FUNCTION	IMAGE	DESCRIPTION	MODEL FUNCTION	IMAGE	DESCRIPTION
<b>6911</b> <b>Entrance(ET)</b>		Pushing/turning button locks outside lever only if use key to release the button or tuning inside lever to unlock the lock.	<b>6913</b> <b>Passage(PS)</b>		Both levers always unlocked.
<b>6912</b> <b>Bathroom(BK)</b>		Can be opened from outside when turning emergency lot, Pushing/turning button locks outside lever, turning inside lever to release button.	<b>6910</b> <b>Dummy(DM)</b>		Dummy trim for oneside of door pull function.

### PRODUCT ITEM



6931RB-ET

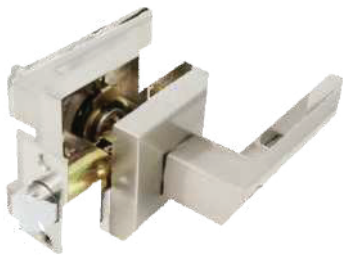

6912SN-BK

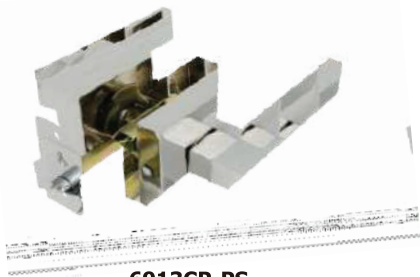

6913CP-PS



6910MB-DM

### STRIKE OPTIONAL

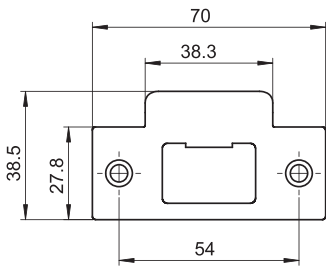

T-Strike

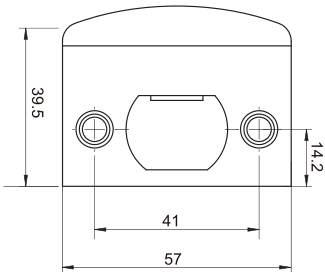

D-Strike

### DOORPREPARATION

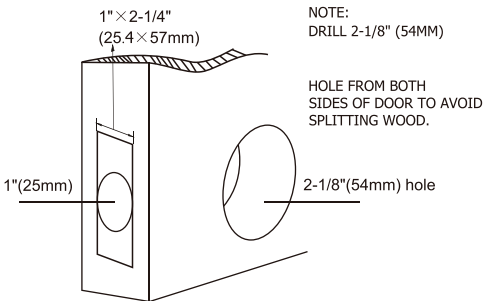

### HOW TO ORDER

**Example:** MODEL: 6911SN-ET  
(US15), Entry 2PC KW Keys, Square Rose,  
adj 60/70 mm latch, D-Strike

**P.S.: The Finish ,Keyway and Package optional in page 01**

**CODE: 6 91 1 SN**

- Finish
- Function
- lever Type
- Series

## 8501 SERIES

### Solid Brass Pitcher Handleset Meets ANSI A156.2 Grade 3

CODE: **8 50 1 -K87-AB**

- **Door Prep:** Cross bore 2-1/8"(54mm) , Edge bore 1"(25mm) , Latch face 1"x2-1/4"(25x57mm).
- **Door Thick:** Fit doors 1-3/8"(35mm) to 2-3/8"(45mm) thick.
- **Backset:** Adjustable 2-3/8"(60mm) or 2-3/4"(70mm).
- **Latch:** Full 1"(25mm) throw deadbolt with hardened bolt; 1/2" throw spring latch smooth operated by thumb piece on outside and knob on inside .
- **Cylinder:** 5 or 6 pin removable core, Schlage C Keyway or Kwikset or YALE or C4 keyway and other optional.
- **Faceplate:** Square corner 1"x2-1/4"(25x57mm) as standard.
- **Strike:** Full lip 1"x2-1/4"(25x57mm) square corner standard; radius corner also available.

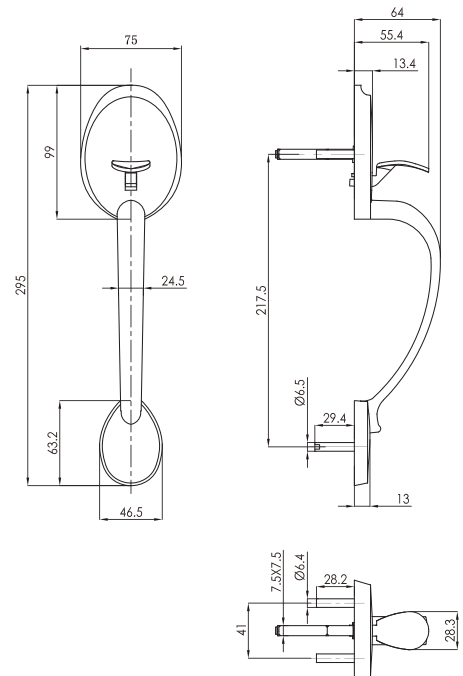
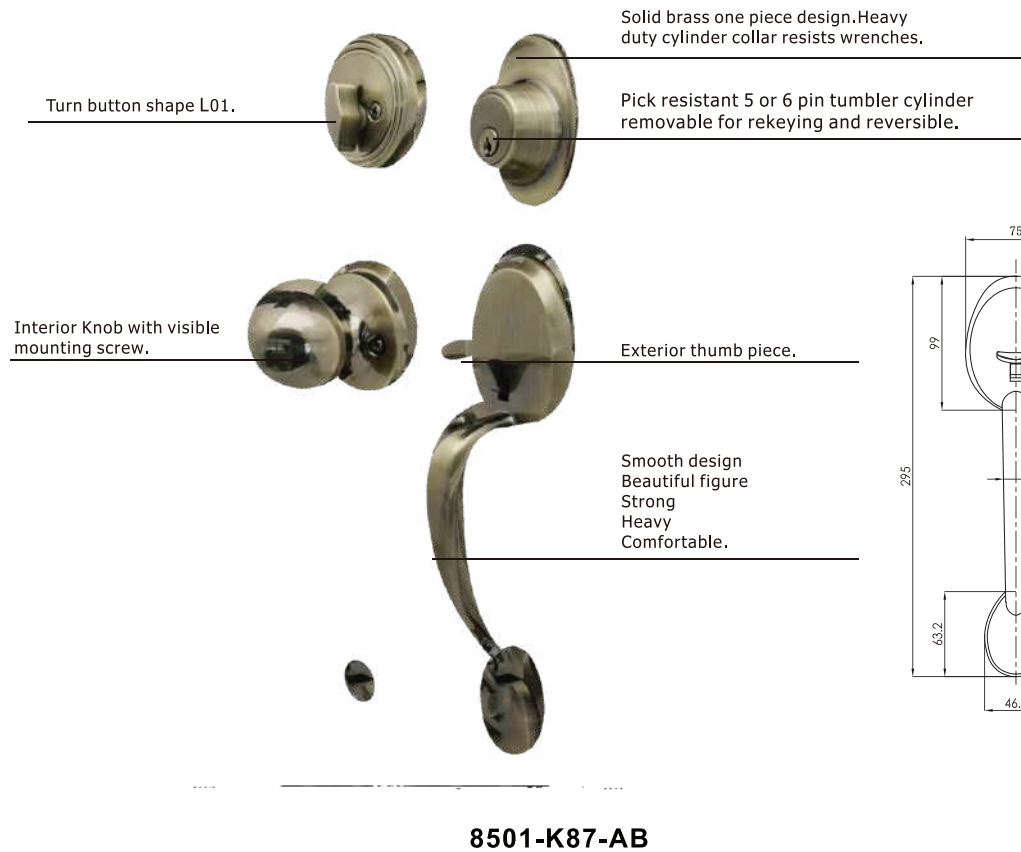
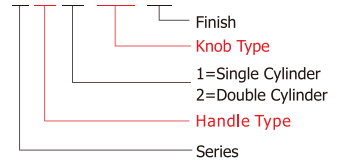

**8501-K87-AB**



**8501-K87-SN**



**8501-L43-SN**

## 8501 SERIES

### Zinc Alloy Pitcher Handleset Meets ANSI A156.2 Grade 3

CODE: 8 50 1 Z-K87-AB

- **Door Prep:** Cross bore 2-1/8"(54mm) , Edge bore 1"(25mm) , Latch face 1"x2-1/4"(25x57mm).
- **Door Thick:** Fit doors 1-3/8"(35mm) to 2-3/8"(45mm) thick.
- **Backset:** Adjustable 2-3/8"(60mm) or 2-3/4"(70mm).
- **Latch:** Full 1"(25mm) throw deadbolt with hardened bolt; 1/2" throw spring latch smooth operated by thumb piece on outside and knob on inside .
- **Cylinder:** 5 or 6 pin removable core, Schlage C Keyway or Kwikset or YALE or C4 keyway and other optional.
- **Faceplate:** Square corner 1"x2-1/4"(25x57mm) as standard.
- **Strike:** Full lip 1"x2-1/4"(25x57mm) square corner standard; radius corner also available.

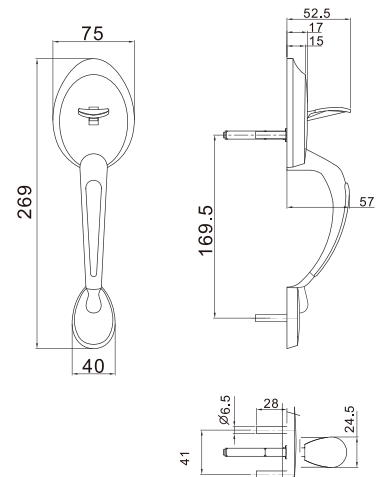
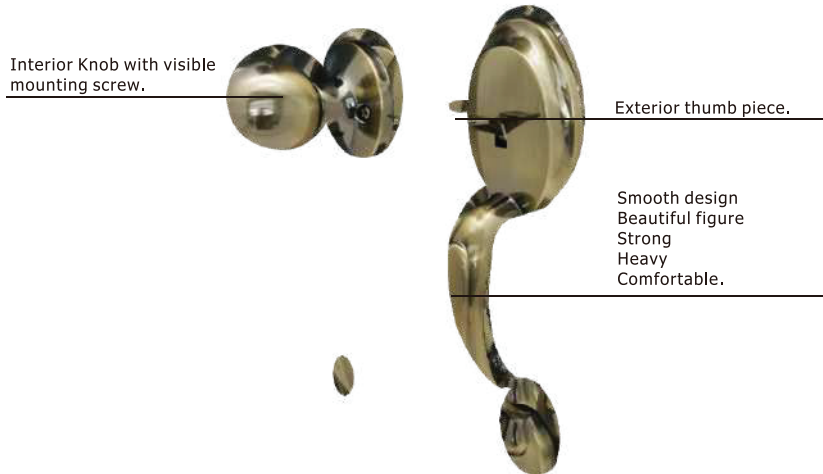
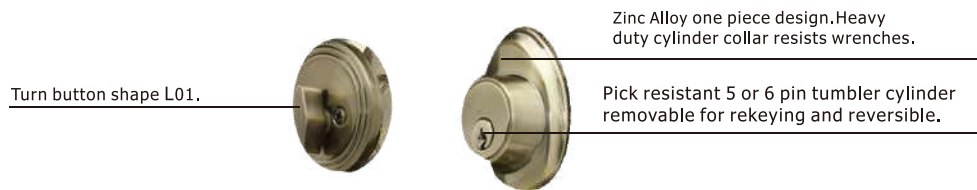
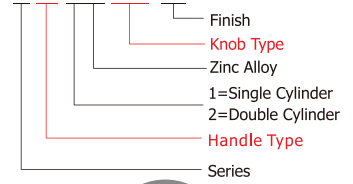

8501Z-K87-AB



8502Z-K87-AB



8501Z-L46-AB

## 8531 SERIES

### Solid Brass Pitcher Handleset Meets ANSI A156.2 Grade 3

- **Door Prep:** Cross bore 2-1/8" (54mm) , Edge bore 1" (25mm) , Latch face 1"x2-1/4" (25x57mm).
- **Door Thick:** Fit doors 1-3/8" (35mm) to 2-3/8" (45mm) thick.
- **Backset:** Adjustable 2-3/8" (60mm) or 2-3/4" (70mm).
- **Latch:** Full 1" (25mm) throw deadbolt with hardened bolt; 1/2" throw spring latch smooth operated by thumb piece on outside and knob on inside .
- **Cylinder:** 5 or 6 pin removable core, Schlage C Keyway or Kwikset or YALE or C4 keyway and other optional.
- **Faceplate:** Square corner 1"x2-1/4" (25x57mm) as standard.
- **Strike:** Full lip 1"x2-1/4" (25x57mm) square corner standard; radius corner also available.

CODE: **8 50 1 -L03-SN**

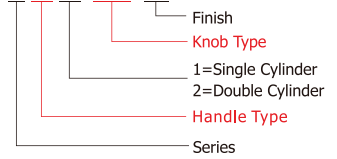

Solid brass one piece design. Heavy duty cylinder collar resists wrenches.

Pick resistant 5 or 6 pin tumbler cylinder removable for rekeying and reversible.



Turn button shape L01.

Exterior thumb piece.

Smooth design  
Beautiful figure  
Strong  
Heavy  
Comfortable.



Interior Lever REVERSIBLE with visible mounting screw.



**8531-L43-SN**

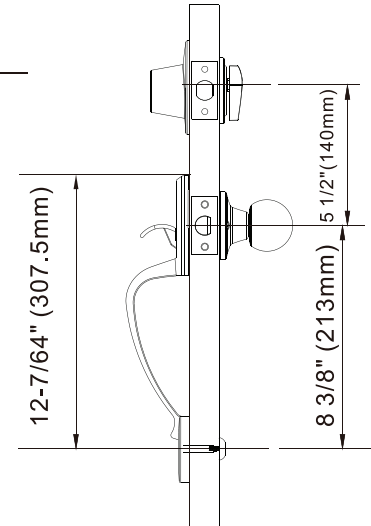

**8531-K87-SN**

## 8521 SERIES

### Solid Brass Pitcher Handleset Meets ANSI A156.2 Grade 3

- **Door Prep:** Cross bore 2-1/8" (54mm) , Edge bore 1" (25mm) , Latch face 1"x2-1/4" (25x57mm).
- **Door Thick:** Fit doors 1-3/8" (35mm) to 2-3/8" (45mm) thick.
- **Backset:** Adjustable 2-3/8" (60mm) or 2-3/4" (70mm).
- **Latch:** Full 1" (25mm) throw deadbolt with hardened bolt; 1/2" throw spring latch smooth operated by thumb piece on outside and knob on inside .
- **Cylinder:** 5 or 6 pin removable core, Schlage C Keyway or Kwikset or YALE or C4 keyway and other optional.
- **Faceplate:** Square corner 1"x2-1/4" (25x57mm) as standard.
- **Strike:** Full lip 1"x2-1/4" (25x57mm) square corner standard; radius corner also available.

CODE: 8 52 1 -K87-RB

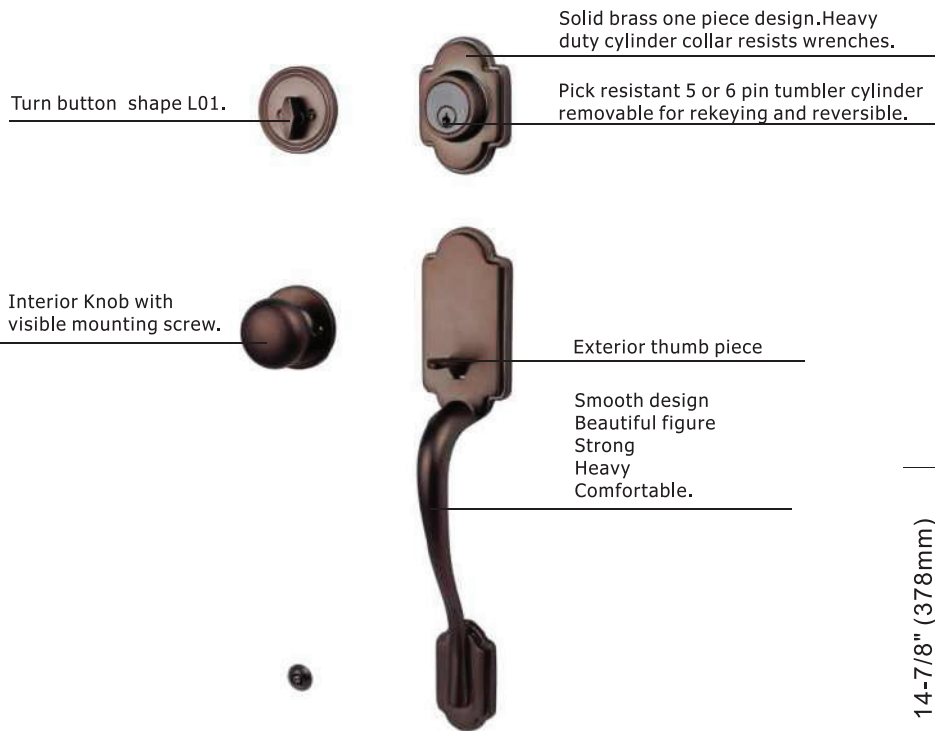
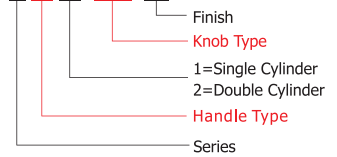

8521-K87-RB

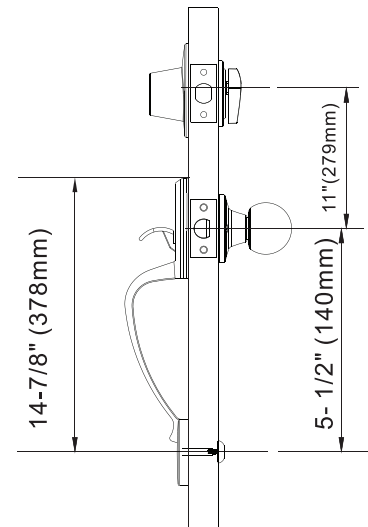

## H8591 SERIES

### Solid Brass Pitcher Handleset

When combined with keylock gives appearance of an expensive. 2-1/8" (54mm) Hole Dia. Fit all makes & models of Tubular & Cylindrical locksets. Simple to install with included fasted screws. Package availbel White Box with label or Individually Display Carded.

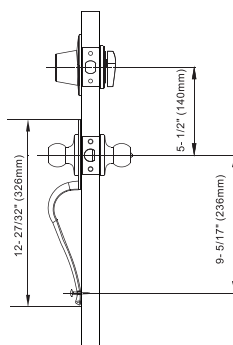



## 80 SERIES

### Zinc Alloy Pitcher Handleset Meets ANSI A156.2 Grade 3

- **Door Prep:** Cross bore 2-1/8" (54mm) , Edge bore 1" (25mm) , Latch face 1"x2-1/4" (25x57mm).
- **Door Thick:** Fit doors 1-3/8" (35mm) to 2-3/8" (45mm) thick.
- **Backset:** Adjustable 2-3/8" (60mm) or 2-3/4" (70mm).
- **Latch:** Full 1" (25mm) throw deadbolt with hardened bolt;  
1/2" throw spring latch smooth operated by thumb piece on outside and knob on inside .
- **Cylinder:** 5 or 6 pin removable core, Schlage C Keyway or Kwikset or YALE or C4 keyway and other optional.
- **Faceplate:** Square corner 1"x2-1/4" (25x57mm) as standard.
- **Strike:** Full lip 1"x2-1/4" (25x57mm) square corner standard; radius corner also available.

CODE: 8 52 1 -K87-RB

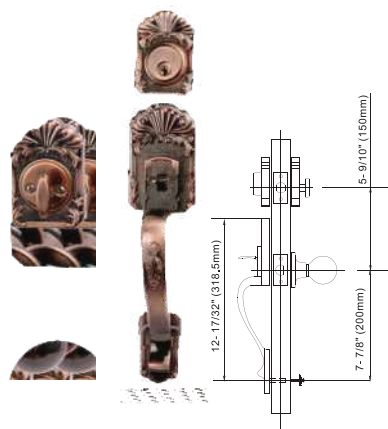
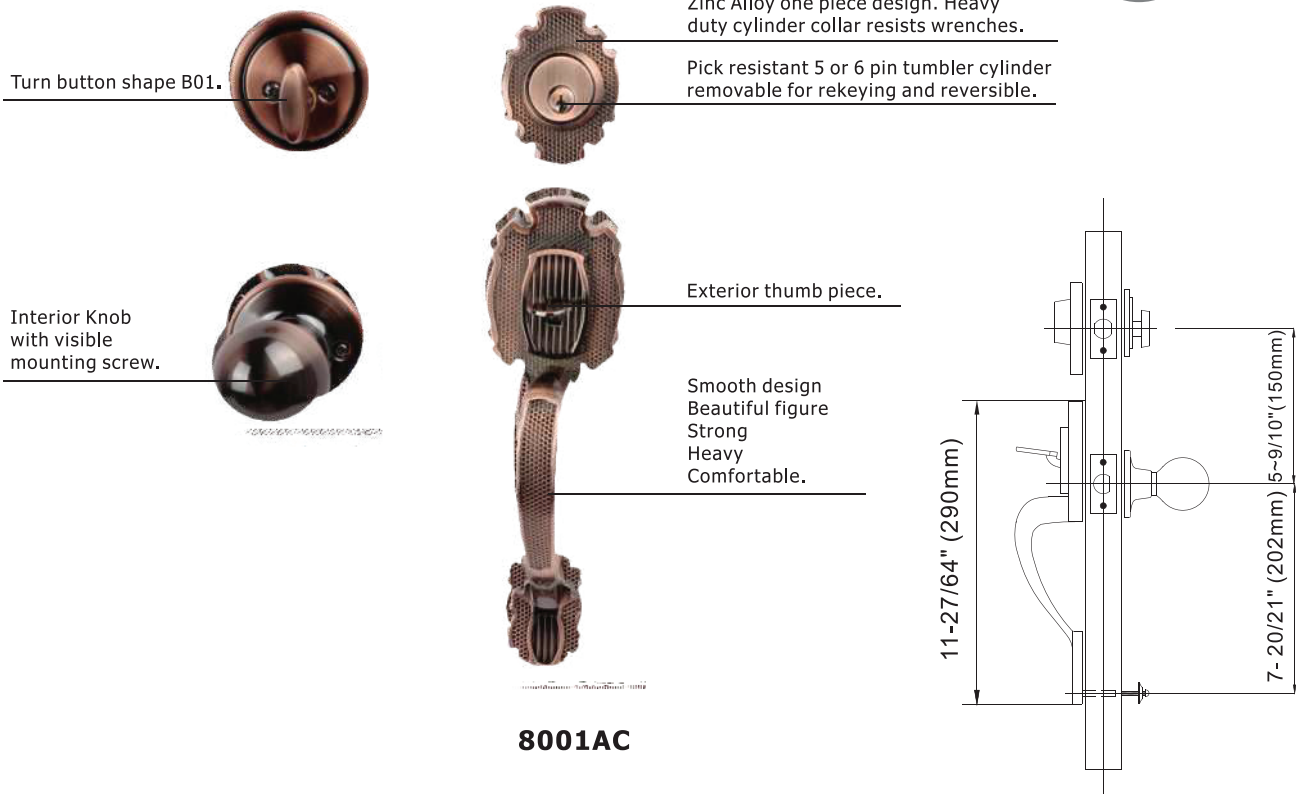
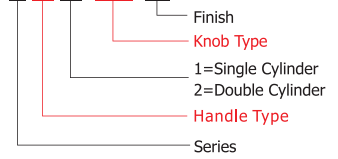

**8021AC**

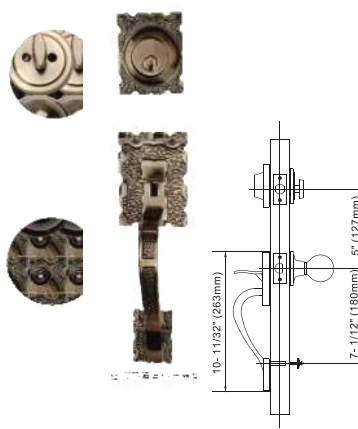

**8041AB**

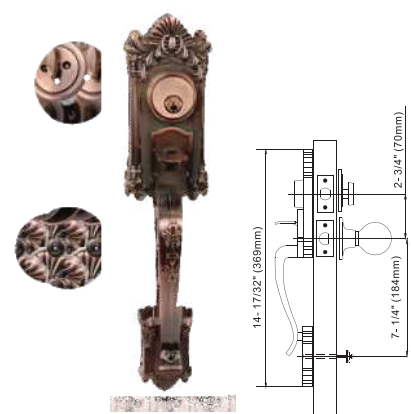

**8071AC**



## 80 SERIES

### Zinc Alloy Pitcher Handleset Meets ANSI A156.2 Grade 3

CODE: 8 02 1 -DH-AB

- **Door Prep:** Cross bore 2-1/8" (54mm) , Edge bore 1" (25mm) , Latch face 1"x2-1/4" (25x57mm).
- **Door Thick:** Fit doors 1-3/8" (35mm) to 2-3/8" (45mm) thick.
- **Backset:** Adjustable 2-3/8" (60mm) or 2-3/4" (70mm).
- **Latch:** Full 1" (25mm) throw deadbolt with hardened bolt; 1/2" throw spring latch smooth operated by thumb piece on outside and knob on inside .
- **Cylinder:** 5 or 6 pin removable core, Schlage C Keyway or Kwikset or YALE or C4 keyway and other optional.
- **Faceplate:** Square corner 1"x2-1/4" (25x57mm) as standard.
- **Strike:** Full lip 1"x2-1/4" (25x57mm) square corner standard; radius corner also available.

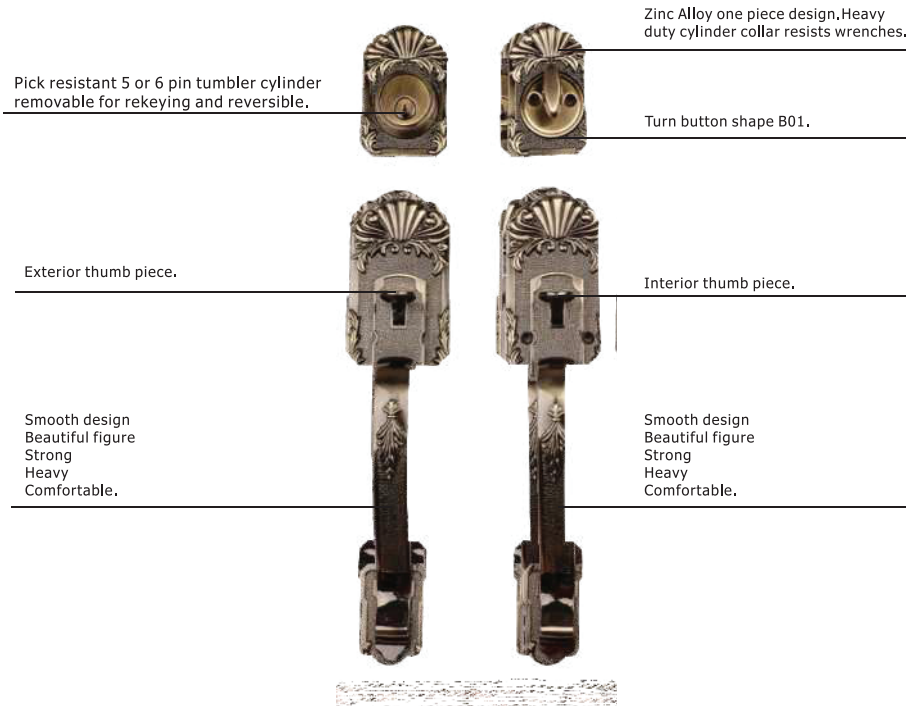
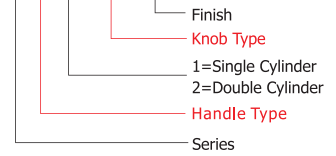

8521DH-AB

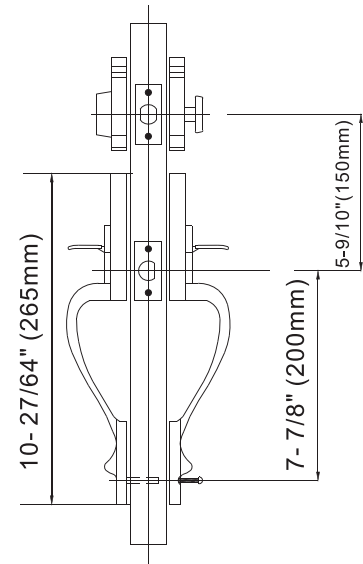

8061DH-AB

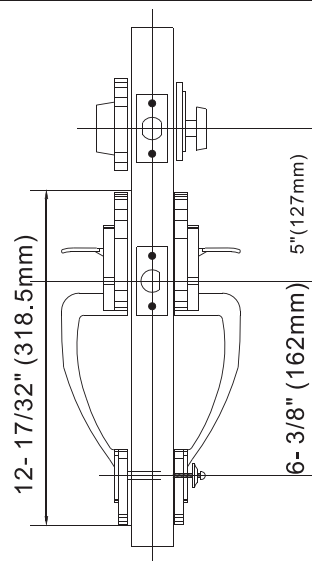

## 82 SERIES

### Zinc Alloy Pitcher Handleset With Completely Mortise Lock Set With Ball Knob For Most of Popular Entrance Key Function.

- **For Doors :** 1-3/4"(45mm) thick
- **Backset:** 2-3/4"(70mm).
- **Front:** Brass armored front 30x203mm.
- **Deadlatch:** 1" throw with a hardened steel rollers
- **Latch Bolt:** 3 point anti-friction type.
- **Stope Works:** Brass, rocker type, chrome plated.
- **Handing:** Handed, easily reversible at job site.
- **Strike:** Brass curved lip. Meets Ansi A115.1
- **Finish:** SN,AB, AC,PVD
- **Cylinder:** Mortise type Brass 5 & 6 pin cylinder  
Can be America Standard Construction keyd (5 "A" HostKey & 1 pc "B"constructon key);  
Schlage C keyway, Kwikset keyway;Dimple key is also available.

CODE: **8 26 1 -SN**



Mortise type Brass 5 & 6 pin cylinder  
Can be CSK, MSK;  
Schlage C keyway, Kwikset keyway;  
Dimple key is also available.

Zinc Alloy one piece design.

Turn Piece.

Exterior thumb piece.

Interior Egg Knob REVERSIBLE  
with spindles and screws.

Smooth design  
Elegant figure  
Strong  
Heavy  
Comfortable.

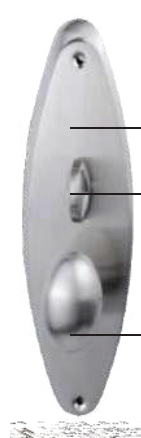

**8261SN**

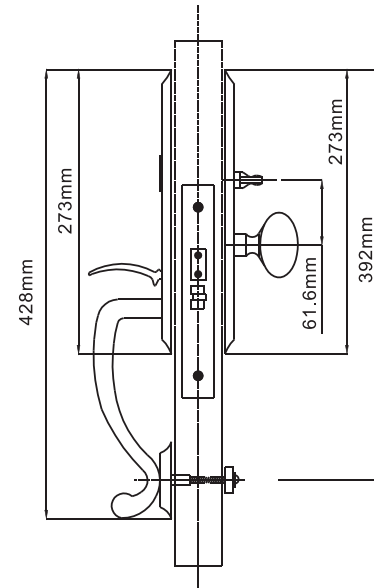

**8271SN**

Armored front plate  
Conceals lock  
mounting screws.

1" Throw Heavy  
Duty deadbolt with  
hardened steel rollers

Heavy Duty 3/4" latchbolt  
with anti-friction latch.

100% internal parts quality  
Inspection provides secure,  
reliability and durability..

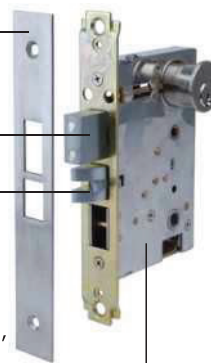

**B9000 Mortise Lock Case**



## 83 SERIES

### Zinc Alloy Pitcher Handleset with Tubular Latch & Deadlatch With ball knob for most of popular entrance key function

CODE: **8 37 1 -SN**

Finish  
Knob Type  
Handle Type  
Series

- **Door Prep:** Cross bore 2-1/8"(54mm) , Edge bore 1"(25mm) , Latch face 1"x2-1/4"(25x57mm).
- **Door Thick :** Fit doors 1-3/8"(35mm) to **2-3/8"(45mm)** thick.
- **Backset:** Adjustable 2-3/8"(60mm) or 2-3/4"(70mm).
- **Latch:** Full 1"(25mm) throw deadbolt with hardened bolt; 1/2" throw spring latch smooth operated by thumb piece on outside and knob on inside .
- **Cylinder:** 5 or 6 pin removable core, Schlage C Keyway or Kwikset or YALE or C4 keyway and other optional.
- **Faceplate:** Square corner 1"x2-1/4"(25x57mm) as standard.
- **Strike:** Full lip D shape Radius 1"x2-1/4"(25x57mm) as standard; Square corner as optional.
- **Finish:** SN, AB, AC, PVD



Mortise type Brass 5 & 6 pin cylinder  
Can be CSK, MSK;  
Schlage C keyway, Kwikset keyway;  
Dimple key is also available.

Exterior thumb piece.

Smooth design  
Elegant figure  
Strong  
Heavy  
Comfortable.

Turn Piece.

Interior Egg Knob REVERSIBLE  
with spindles and screws.

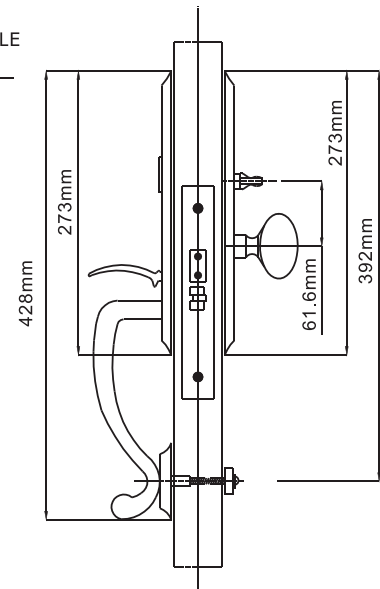

**8361SN**



**8371SN**